



FORD & PARTNERS

— ESTATE AGENTS —



Flat 1, Midsummer Court Penn Road, Hazlemere, High Wycombe, Buckinghamshire, HP15 7LD



Flat 1, Midsummer Court Penn Road, Hazlemere, High Wycombe,
Buckinghamshire, HP15 7LD

199 Year Lease & Peppercorn Ground Rent

A two bedroom purpose-built ground floor apartment situated in the heart of Hazlemere.
Midsummer Court is a private development of just 8 apartments.

**Asking price
£275,000**

Description

When entering the property through the front door, you greeted into the central hallway with the separate kitchen on your right hand side. Also off the hallway, you have the family bathroom, access into the two double bedrooms with the master bedroom benefiting from an ensuite, and the sitting room. The sitting room enjoys a double aspect south-facing view with patio doors leading out onto a secluded patio and lawned area.

Further features include, double glazing, gas central heating, video entry system and allocated parking. The property is being sold with no onward chain.

Situation

Midsummer Court is situated in the heart of Hazlemere with plenty of amenities just a stones throw away - perfect if you're looking to downsize and wanting to be close to a bus stop & shopping facilities. Hazlemere benefits from an array of shops such as Little Waitrose, a hair & barber shop, a butchers, a pharmacy and many more.



Floor Plans

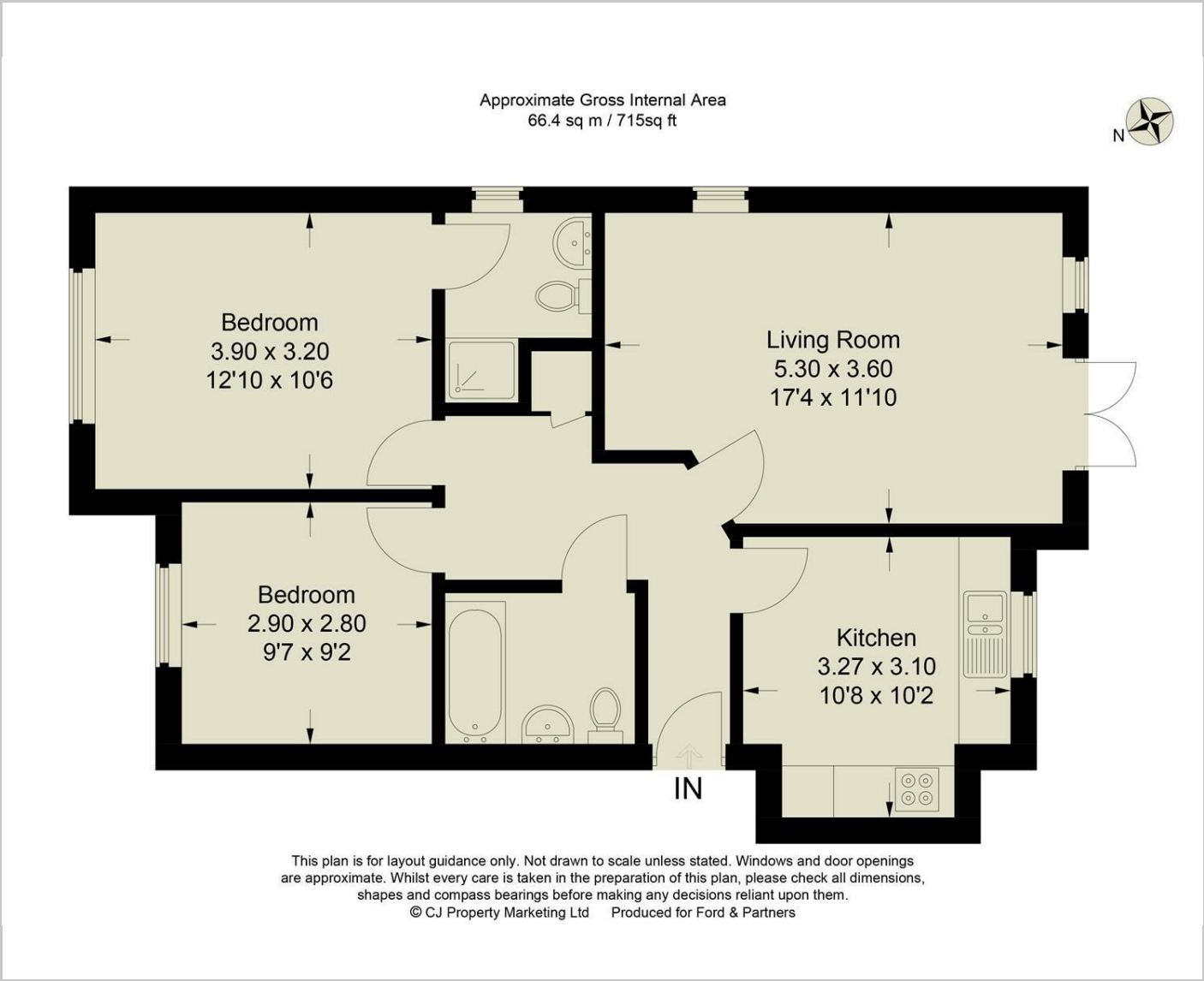

Area Map



Energy Performance Graph

