

39 High Street, Maidenhead, Berkshire SL6 1JF

Tel: 01628 674234 Fax: 01628 785432

Email: property@braxtons.co.uk

braxtons.co.uk



Residential Sales | Land & New Homes | Properties to Let | Landlords, Lettings and Management Services



PRICE: £264,950 SHARE OF FREEHOLD

**LOWER COOKHAM ROAD, MAIDENHEAD
BERKSHIRE SL6 8JL**

A delightful one bedroom ground floor apartment in this attractive gated development within walking distance of the River Thames at Boulters Lock. The property, in our opinion, is presented in excellent decorative order and features a recently re-fitted bathroom suite.
NO ONWARD CHAIN.

***GATED DEVELOPMENT *COMMUNAL ENTRANCE HALL *PRIVATE ENTRANCE HALL
*LIVING/DINING ROOM *KITCHEN *NEWLY RE-FITTED BATHROOM *DOUBLE BEDROOM
WITH FITTED WARDROBES *STUNNING COMMUNAL GROUNDS *ALLOCATED CAR PORT
PARKING SPACE *CONVENIENTLY SITUATED WITHIN WALKING DISTANCE OF THE RIVER
THAMES AT BOULTERS LOCK *EASY REACH OF THE TOWN CENTRE *NO ONWARD CHAIN
*EPC RATING E**



DIRECTIONS

Proceed east out of Maidenhead along the A4 Bath Road and turn left immediately after the Texaco petrol station into Ray Mead Road. Continue along passing Boulters Lock on the right, the road then becomes Lower Cookham Road and after passing Lock Avenue on the left, Mead Haze will be seen on the left hand side, clearly marked by our 'For Sale' board.

ACCOMMODATION





For clarification we wish to inform prospective purchasers that we have prepared these sales particulars as a general guide. We have not carried out a detailed survey nor tested the services, appliances and specific fittings. Room sizes should not be relied upon for carpets, furnishings and appliances. Whilst these particulars are believed to be correct their accuracy is not guaranteed and are given without responsibility. They do not form part of any contract.

MW3455

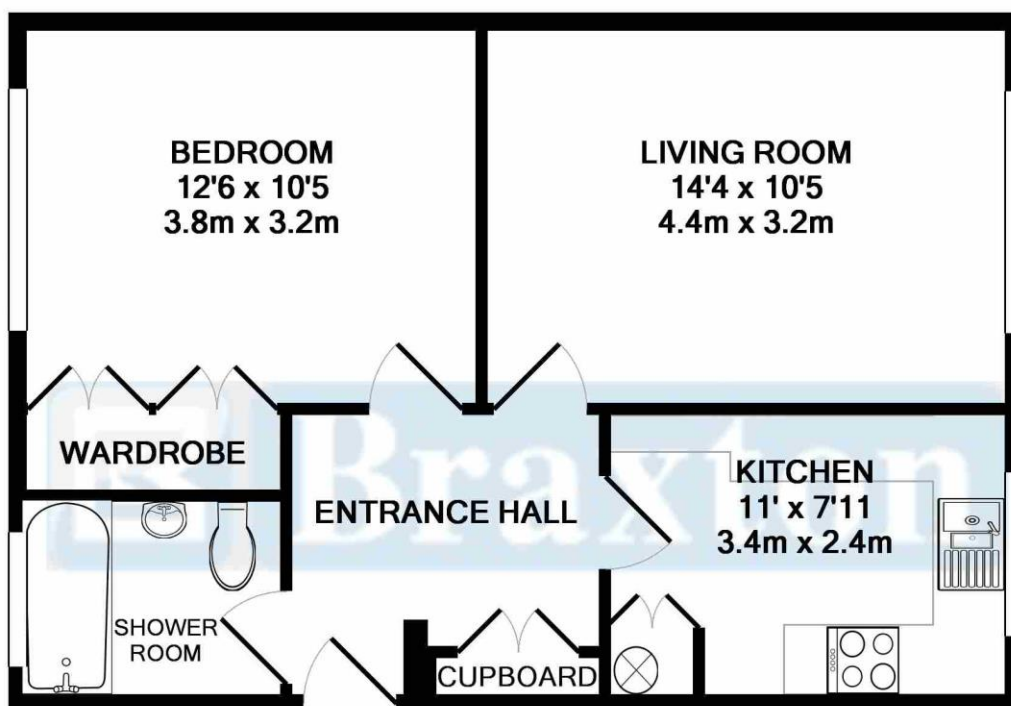

TOTAL APPROX. FLOOR AREA 489 SQ.FT. (45.4 SQ.M.)

Whilst every attempt has been made to ensure the accuracy of the floor plan contained here, measurements of doors, windows, rooms and any other items are approximate and no responsibility is taken for any error, omission, or mis-statement. This plan is for illustrative purposes only and should be used as such by any prospective purchaser. The services, systems and appliances shown have not been tested and no guarantee as to their operability or efficiency can be given
Made with Metropix ©2019

