

39-41 High Street, Maidenhead, Berkshire SL6 1JF

Tel: 01628 674234 Fax: 01628 785432

Email: [property@braxtons.co.uk](mailto:property@braxtons.co.uk)

[braxtons.co.uk](http://braxtons.co.uk)



Residential Sales | Land & New Homes | Properties to Let | Landlords, Lettings and Management Services



**PRICE: £399,950 FREEHOLD**

**42 QUEENSWAY, MAIDENHEAD, BERKSHIRE SL6 7SD**

Located north of Maidenhead town centre and within easy reach of local amenities, good schools and Furze Platt railway station (branch line to Maidenhead). A well presented three bedroom end of terrace home with scope to extend, subject to the necessary planning consents being obtained. The property features a spacious kitchen/dining room, upstairs family bathroom and low-maintenance rear garden with outbuilding for potential office/utility.

Highly recommended.

**\* ENTRANCE HALL \* LIVING ROOM \* SPACIOUS KITCHEN/DINING ROOM \* THREE BEDROOMS \* FAMILY BATHROOM \* LOW-MAINTENANCE REAR GARDEN WITH OUTBUILDING FOR POTENTIAL OFFICE/UTILITY \* RESIDENT PARKING \* EPC RATING TBC \* NO ONWARD CHAIN**



## DIRECTIONS

Proceed north along the Cookham Road (B4447) and on reaching the fourth mini roundabout with the row of shops on the right, turn left into Harrow Lane. Proceed up Harrow Lane, over the level crossing and turn right into Queensway where the property will be found after a short distance on the right hand side.

## ACCOMMODATION







For clarification we wish to inform prospective purchasers that we have prepared these sales particulars as a general guide. We have not carried out a detailed survey nor tested the services, appliances and specific fittings. Room sizes should not be relied upon for carpets, furnishings and appliances. Whilst these particulars are believed to be correct their accuracy is not guaranteed and are given without responsibility. They do not form part of any contract.

ST3663

GROUND FLOOR  
439 sq.ft. (40.8 sq.m.) approx.

1ST FLOOR  
414 sq.ft. (38.5 sq.m.) approx.

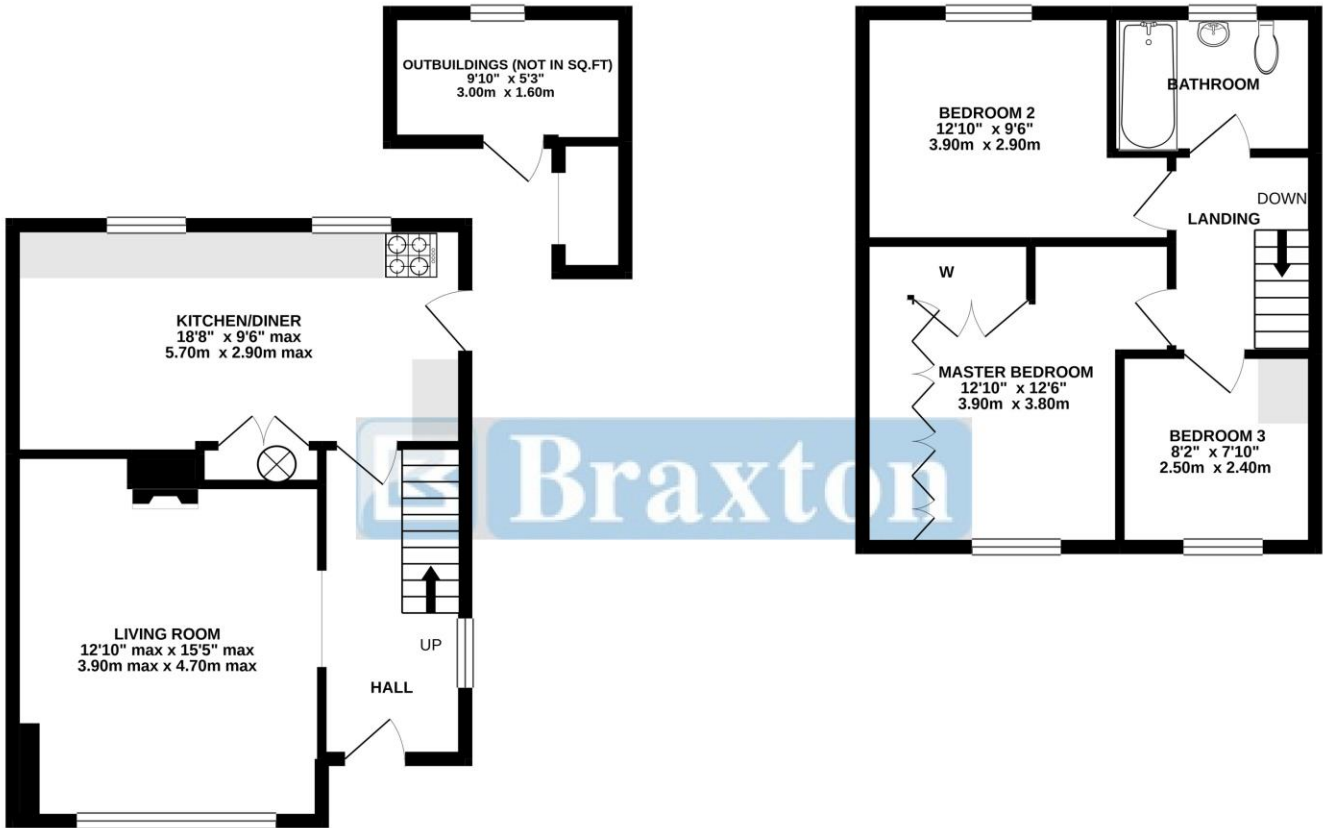

TOTAL FLOOR AREA : 854sq.ft. (79.3 sq.m.) approx.

Whilst every attempt has been made to ensure the accuracy of the floorplan contained here, measurements of doors, windows, rooms and any other items are approximate and no responsibility is taken for any error, omission or mis-statement. This plan is for illustrative purposes only and should be used as such by any prospective purchaser. The services, systems and appliances shown have not been tested and no guarantee as to their operability or efficiency can be given.  
Made with Metropix ©2021

