

39-41 High Street, Maidenhead, Berkshire SL6 1JF

Tel: 01628 674234 Fax: 01628 785432

Email: property@braxtons.co.uk

braxtons.co.uk



Residential Sales | Land & New Homes | Properties to Let | Landlords, Lettings and Management Services



PRICE: OFFERS OVER £475,000 FREEHOLD

76 TREESMILL DRIVE, MAIDENHEAD, BERKSHIRE, SL6 3HS

An opportunity to acquire this delightful three bedroom semi-detached family house which has been the subject of refurbishment by the present owners to provide modern contemporary living which features a generous sitting room, re-fitted cloakroom, re-fitted kitchen opening into the dining room, three bedrooms and a re-fitted bathroom suite. The property is conveniently located for local schools and within approx. 1.3 Miles of Maidenhead railway station (Paddington/Elizabeth Line).

*** ENTRANCE HALL * RE-FITTED CLOAKROOM * SITTING ROOM * DINING ROOM * RE-FITTED KITCHEN * THREE BEDROOMS * RE-FITTED BATHROOM * DOUBLE GLAZING & GAS HEATING
* DELIGHTFUL ENCLOSED WEST FACING REAR GARDEN * GARAGE * PARKING SPACE
* CONVENIENT LOCATION * EPC RATING C**



DIRECTIONS for SAT NAV: SL6 3HS
Council Tax Band D – currently £1558.34 per annum

ACCOMMODATION





For clarification we wish to inform prospective purchasers that we have prepared these sales particulars as a general guide. We have not carried out a detailed survey nor tested the services, appliances and specific fittings. Room sizes should not be relied upon for carpets, furnishings and appliances. Whilst these particulars are believed to be correct their accuracy is not guaranteed and are given without responsibility. They do not form part of any contract.

MW3953

Treemill Drive, Maidenhead, SL6

Approximate Area = 1014 sq ft / 94 sq m (includes garage)

For identification only - Not to scale

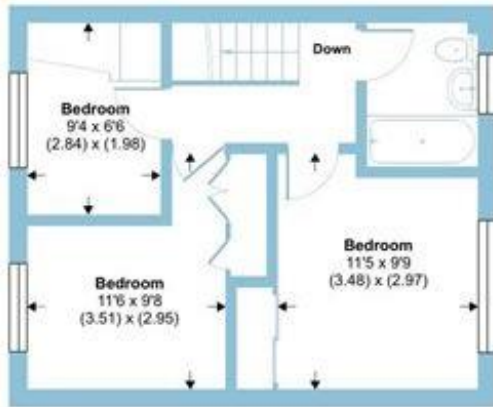

FIRST FLOOR



Illustration for identification purposes only, measurements are approximate, not to scale.

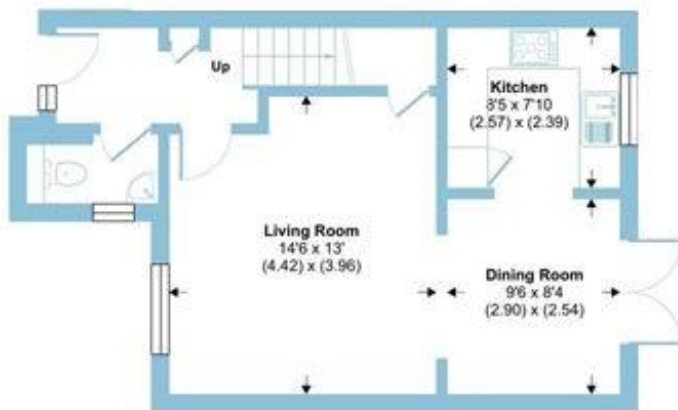

GROUND FLOOR

