

39 High Street, Maidenhead, Berkshire SL6 1JF

Tel: 01628 674234 Fax: 01628 785432

Email: property@braxtons.co.uk

braxtons.co.uk



Residential Sales | Land & New Homes | Properties to Let | Landlords, Lettings and Management Services



GUIDE PRICE £230,000 LEASEHOLD

FLAT 4, 22 CRAUFURD RISE, MAIDENHEAD, BERKSHIRE, SL6 7LS

Located within walking distance of Maidenhead town centre and railway station (ELIZABETH LINE). A spacious and well-appointed one-bedroom first floor flat featuring a double bedroom, large living/dining room, bathroom with shower over bath, modern fitted kitchen and allocated parking.

- SPACIOUS FIRST FLOOR APARTMENT • WALKING DISTANCE TO TOWN/STATION • LARGE LIVING/DINING ROOM • PRIVATE PARKING • FITTED KITCHEN • DOUBLE BEDROOM • LONG LEASE • IDEAL FOR FIRST TIME BUYER • PRIVATE ENTRANCE HALL • EPC RATING E





LEASE: 146 YEARS REMAINING

SERVICE CHARGE: £150.00 PER ANNUM

GROUND RENT: £100.00 PER ANNUM

ACCOMMODATION





For clarification we wish to inform prospective purchasers that we have prepared these sales particulars as a general guide. We have not carried out a detailed survey nor tested the services, appliances and specific fittings. Room sizes should not be relied upon for carpets, furnishings and appliances. Whilst these particulars are believed to be correct their accuracy is not guaranteed and are given without responsibility. They do not form part of any contract.

481 sq.ft. (44.7 sq.m.) approx.

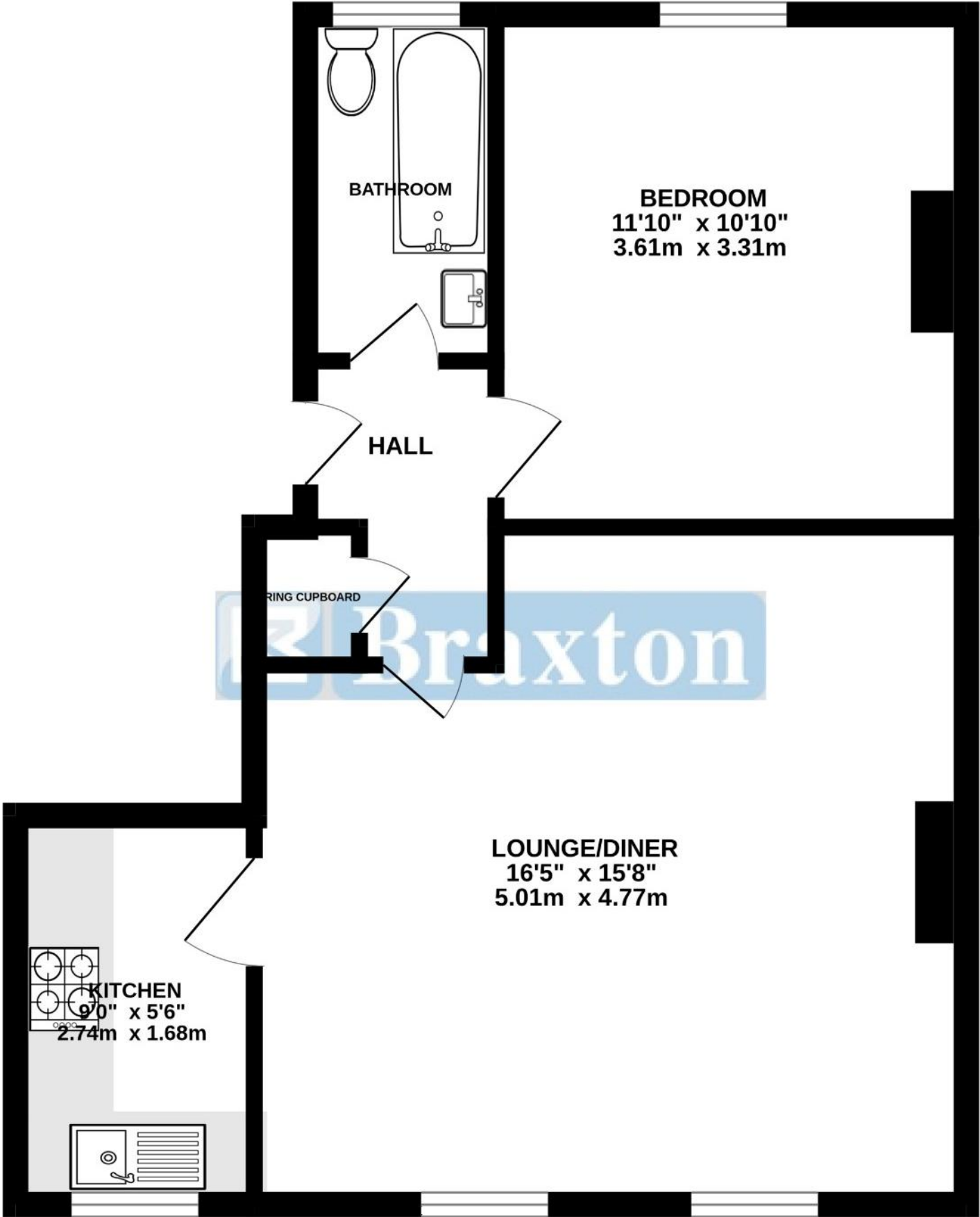

TOTAL FLOOR AREA : 481 sq.ft. (44.7 sq.m.) approx.

Whilst every attempt has been made to ensure the accuracy of the floorplan contained here, measurements of doors, windows, rooms and any other items are approximate and no responsibility is taken for any error, omission or mis-statement. This plan is for illustrative purposes only and should be used as such by any prospective purchaser. The services, systems and appliances shown have not been tested and no guarantee as to their operability or efficiency can be given.
Made with Metropix ©2025

