



8 NORFOLK PARK COTTAGES, MAIDENHEAD, BERKSHIRE, SL6 7DR

8 NORFOLK PARK COTTAGES, MAIDENHEAD, BERKSHIRE, SL6 7DR

GUIDE PRICE £495,000

An opportunity to acquire this delightful two-bedroom extended character cottage which has been the subject of refurbishment by the present owners and features include a stunning “hub of the house” kitchen/dining/family room with direct access onto the rear garden, a re-fitted cloak/utility room and two good size bedrooms with a modern bathroom suite. The property occupies a tucked away position which is conveniently located for local shops, schools and within approx. 0.6 Miles of the mainline railway station (Paddington/Elizabeth Line).

- CLOAK/UTILITY ROOM •
- KITCHEN/DINING/FAMILY ROOM •
- LIVING ROOM • TWO BEDROOMS •
- BATHROOM • LANDSCAPED REAR GARDEN •
- DRIVEWAY PARKING •
- RECENTLY REPLACED GAS BOILER •
- CONVENIENT POSITION • EPC RATING D •
- COUNCIL TAX BAND C







Norfolk Park Cottages

Approximate Gross Internal Area = 73.4 sq m / 790 sq ft

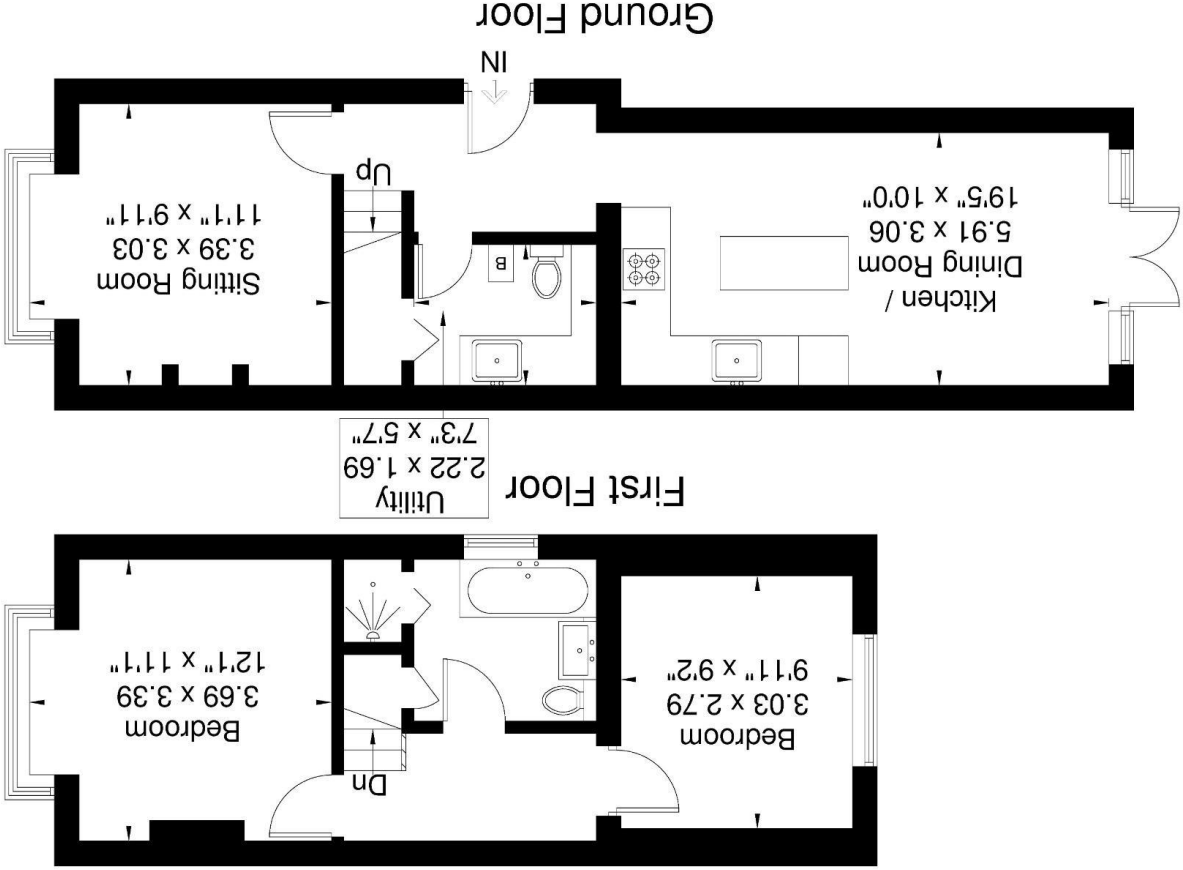

Illustration for identification purposes only,
measurements are approximate, not to scale.

For clarification we wish to inform prospective purchasers that we have prepared these sales particulars as a general guide. We have not carried out a detailed survey nor tested the services, appliances and specific fittings. Room sizes should not be relied upon for carpets, furnishings and appliances. Whilst these particulars are believed to be correct their accuracy is not guaranteed and are given without responsibility. They do not form part of any contract.

braxtons.co.uk

Email: property@braxtons.co.uk

Tel: 01628 674234 Fax: 01628 785432

39 High Street, Maidenhead, Berkshire SL6 1JF

Braxton



Residential Sales | Land & New Homes | Properties to Let | Landlords, Lettings and Management Services

PrimeLocation.com

The Property Ombudsman

Zoopla

naed | propertymark
PROTECTED

rightmove.co.uk
The UK's number one property website



nTheMarket