



WINTER HOUSE, WALTHAM ROAD, WHITE WALTHAM, BERKSHIRE, SL6 3SH

WINTER HOUSE, WALTHAM ROAD, WHITE WALTHAM, BERKSHIRE SL6 3SH

GUIDE PRICE £1,750,000
FREEHOLD

Situated in the popular White Waltham Village close to the Cricket Pitch and White Waltham C of E Academy is this delightful and well-presented Five Bedroom detached family home providing over 3,144 square feet of living space occupying a mature landscaped plot of just under 0.5 Acre. The property features a double aspect living room, separate study and large modern kitchen/breakfast room opening into a generous family/dining room as well as five bedrooms and four bath/shower rooms (three en-suite) with ample parking and large triple length garage. NO CHAIN

***GATED DRIVEWAY *GENEROUS RECEPTION HALL WITH GALLERIED LANDING
*CLOAKROOM *LIVING ROOM *STUDY
*LARGE KITCHEN/BREAKFAST ROOM
*OPENING INTO DINING/FAMILY ROOM
*MAIN BEDROOM SUITE WITH EN-SUITE SHOWER ROOM *GUEST BEDROOM WITH EN-SUITE BATHROOM *THIRD BEDROOM WITH EN-SUITE SHOWER ROOM *TWO FURTHER BEDROOMS *FAMILY BATHROOM
*ENCLOSED GARDENS *EXTENSIVE DRIVEWAY PARKING *TRIPLE LENGTH GARAGE *NO CHAIN *EPC RATING D
*COUNCIL TAX BAND G**





Waltham Road

Approximate Gross Internal Area = 292.1 sq m / 3144 sq ft
Garage = 47.7 sq m / 513 sq ft
Total = 339.8 sq m / 3657 sq ft

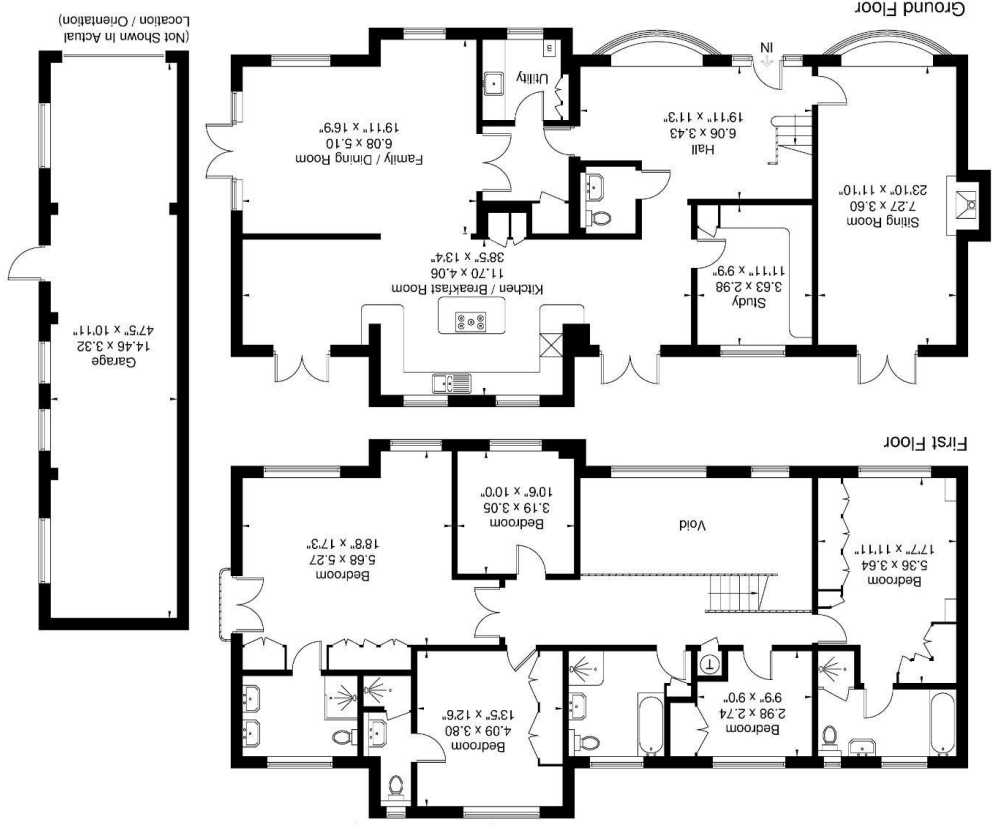

Illustration for identification purposes only,
measurements are approximate, not to scale.

For clarification we wish to inform prospective purchasers that we have prepared these sales particulars as a general guide. We have not carried out a detailed survey nor tested the services, appliances and specific fittings. Room sizes should not be relied upon for carpets, furnishings and appliances. Whilst these particulars are believed to be correct their accuracy is not guaranteed and are given without responsibility. They do not form part of any contract.



braxtons.co.uk

Email: property@braxtons.co.uk

Tel: 01628 674234 Fax: 01628 785432

39 High Street, Maidenhead, Berkshire SL6 1JF

Residential Sales | Land & New Homes | Properties to Let | Landlords, Lettings and Management Services

