



63 Wykeham Field
Wickham
Hampshire
PO17 5AD



Tel: 01329 834579 www.byrnerunciman.co.uk

63 WYKEHAM FIELD

PRICE GUIDE: £299,950

The Property

A semi-detached house close to the centre of the historic village of Wickham which offers all local amenities. Number 63 is believed to have been built in the 1960s. It is a three bedroom family home offering a good sized living room, kitchen/breakfast room, cloakroom, shower room and an enclosed rear garden. Viewing is very highly recommended.

- * **NO ONGOING CHAIN ***
- * **LIVING ROOM ***
- * **KITCHEN/BREAKFAST ROOM ***
- * **THREE BEDROOMS ***
- * **SHOWER ROOM ***
- * **ENCLOSED REAR GARDEN ***
- * **VILLAGE LOCATION ***

The Location

Wickham is an historic village at the southern end of the Meon Valley and offers all local amenities. The larger centre of Fareham is close by with easy access to the M27 motorway network.

Directions

From our offices travel down Bridge Street and at the junction by the church turn right onto School Road and after a short distance turn right again into Wykeham Field and the property will be found immediately on the right hand side.

ACCOMMODATION

CANOPY PORCH Double glazed front door, with adjacent double glazed window panel, opening to:

ENTRANCE HALL Staircase to first floor, electric heater*, doors opening to:

CLOAKROOM Double glazed window to front, high level w.c., wash hand basin, partially tiled walls.

LIVING ROOM Double glazed windows to front, side and rear, chimney breast with fitted gas fire*.

KITCHEN/BREAKFAST ROOM Double glazed window to rear, fitted with a range of wall and base unit with work surfaces over, single drainer sink unit with cupboard below, built in electric oven*, gas hob* with extractor* over, partially tiled walls, plumbing for washing machine, under stairs cupboard, further storage recess, double glazed door opening to garden.

FIRST FLOOR

LANDING Loft hatch, airing cupboard housing hot water tank, electric heater*, doors opening to:

BEDROOM ONE Double glazed window to front, built in wardrobe.

BEDROOM TWO Double glazed window to front, built in wardrobe.

BEDROOM THREE Double glazed window to rear, wardrobe recess.

SHOWER ROOM Double glazed window to rear, suite comprising tiled shower cubicle, pedestal wash hand basin, low level w.c., partially tiled walls, heated towel rail*.

OUTSIDE

The **FRONT GARDEN** has a paved area, some shrubs and a pathway to the front door.

The enclosed **REAR GARDEN** is laid to lawn, a patio area, some shrubs and borders, shed and pedestrian gates to the rear and side.

OUTBUILDING Window to rear, door to garden.

SERVICES: All main services.

TENURE: Freehold.

LOCAL AUTHORITY: Winchester District Council.

COUNCIL TAX BAND: C.

Agents Note: * *We have not inspected or tested any of the service installations, equipment or appliances. It is recommended that any purchasers arrange for suitable inspections and tests by qualified engineers prior to entering into any contract. All measurements contained herein are to be considered approximate only.*

Viewing strictly by appointment with vendor's sole agent BYRNE RUNCIMAN of Wickham.



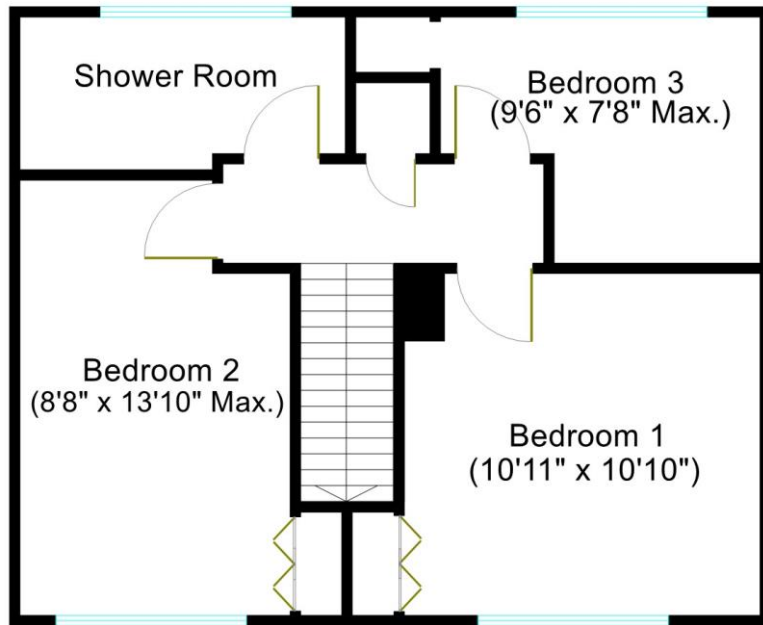

First Floor

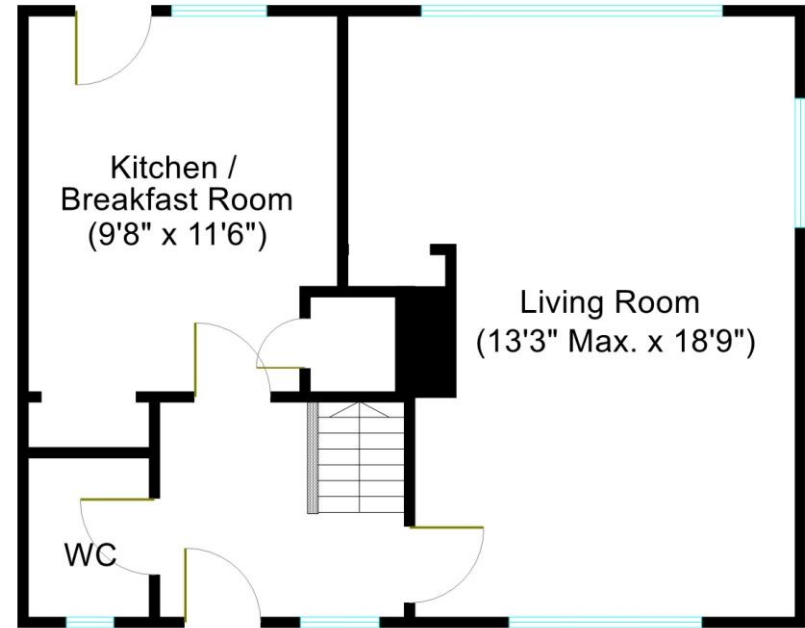

Ground Floor



Total Approx. internal floor area = 897.6 sq ft / 83.4 sqm
Floor Plan for identification and guidance purposes only

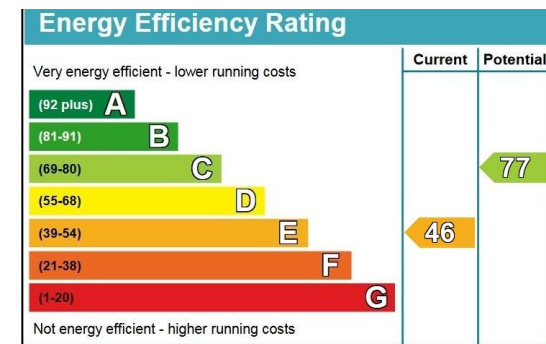

Byrne Runciman, for purchasers and for the vendor of this property, as agent, give notice that:

1. All statements contained in these particulars are as a general guide only, and are made without responsibility on the part of the agent or the vendors. They are not to be relied upon as statements or representation of fact, and any intending purchaser must satisfy himself by inspection or otherwise as to their correctness.
2. The vendor does not make or give, and neither the agent nor any person in his employ, has any authority to make or give, whether in these particulars or during negotiations, any representation or warranty whatsoever in relation to this property.
3. These particulars do not constitute any part of an offer or contract.

