



3 THE CLIFFS, BURLINGTON ROAD, SWANAGE
£475,000 Leasehold

This luxury apartment is situated within a prestigious development of fourteen superb contemporary styled apartments, occupying an elevated clifftop position in the sought after area of North Swanage. No 3 The Cliffs is a well-planned, spacious apartment with stylish interior design fitted with luxury fixtures throughout including quality kitchen units with granite worktops and Miele integrated appliances, Villeroy and Boch bathroom suites, underfloor heating, video entry system, lift access to all floors, gated parking and private paved terrace.

“The Cliffs” is set in its own landscaped grounds and is ideally located for access to Swanage beach and approximately 1 mile from the town centre and main shopping thoroughfare.

The seaside resort of Swanage incorporates the Jurassic Coast which is part of the World Heritage Coastline, and is situated some 9 miles from the market town of Wareham which has main line rail link to London Waterloo (approximately 2½ hours). The popular conurbations of Poole and Bournemouth are also a short distance away.

Property Reference BUR1783

Council Tax Band E



Upon entering the apartment, the entrance hall leads to the spacious open plan living room/dining room and fully fitted kitchen. This room has dual aspects providing a light and airy environment and glimpses of Swanage Bay, double doors lead to the paved terrace with glimpses of the Purbeck Hills. There are two double bedrooms, the master has the benefit of an en-suite shower room. The family bathroom completes the accommodation.

Outside, the personal paved terrace stands in the landscaped communal grounds. An electronically operated gate provides access to a reserved secure underground parking space.

Tenure: Leasehold, 125 years from 2010. Current service charge £1,625 pa (paid in two half yearly instalments). Ground rent £250 pa for the first 25 years. Long lets and holiday lets are permitted. Pets at the discretion of the freeholder. The current owners pay £250pa for the use of a personal store cupboard located in the garage, which is available if required.

Viewing is highly recommended to appreciate this stylish apartment. Viewings must be accompanied and are strictly by appointment through **Corbens, 01929 422284.**

Ground Floor

Total Habitable Area Approx. 73 m² (786 sq ft)

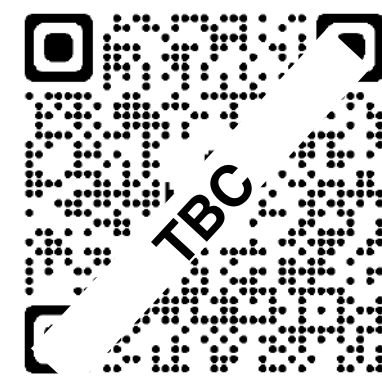
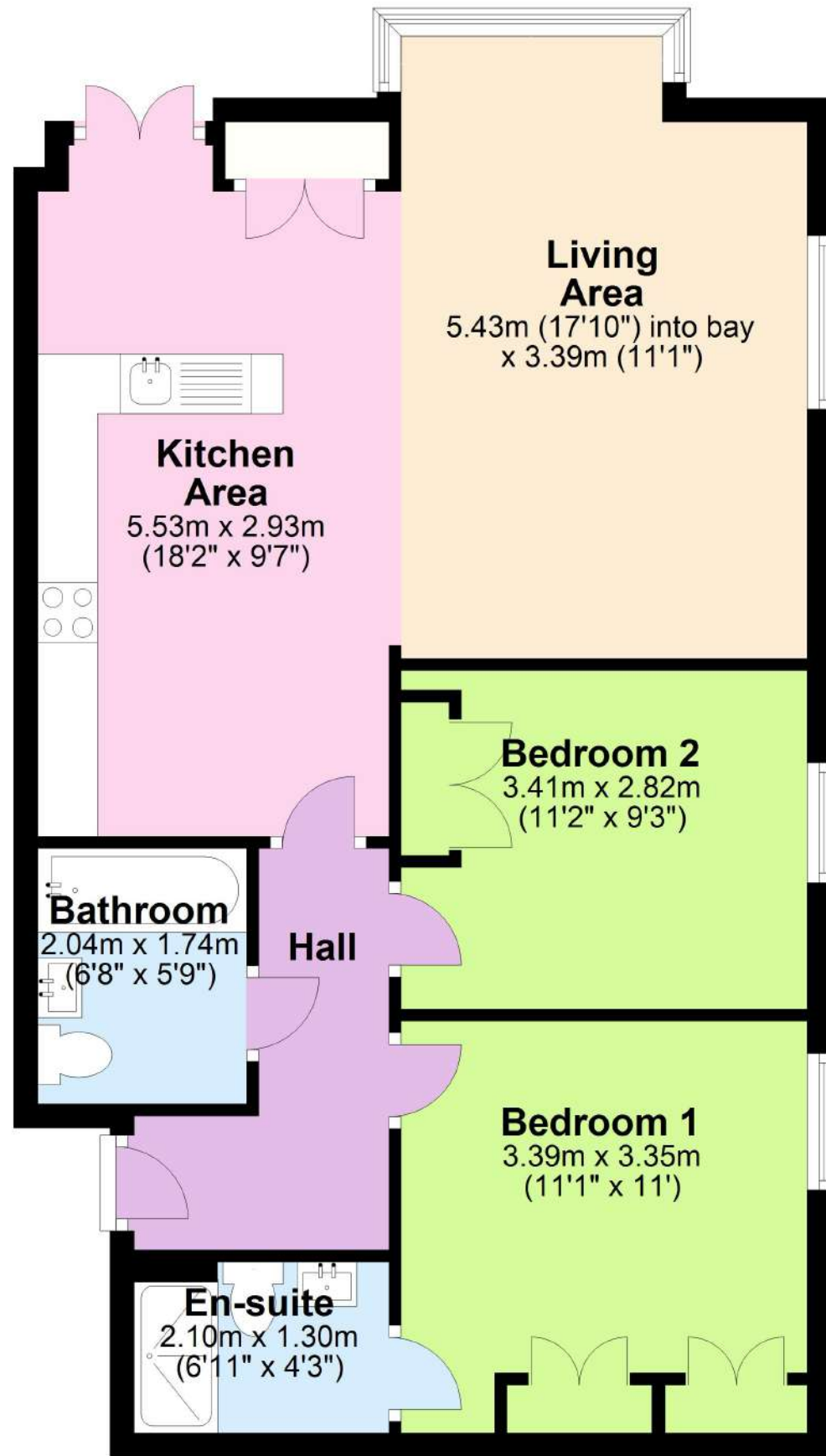

Scan to View Video Tour

THE PROPERTY MISDESCRIPTION ACT 1991 You are advised to check the availability of this property before travelling any distance to view. The Agent has not tested any apparatus, equipment, fixtures and fittings or services and so cannot verify that they are in working order or fit for the purpose. References to the Tenure of a Property are based on information supplied by the Seller. The area of the building is given for guidance purposes only and must be verified by the purchasers surveyor. A Buyer is advised to obtain verification of this information from their Solicitor and/or Surveyor. FLOOR PLANS The floor plans supplied are for guidance purposes only and should not be used for measuring. Small recesses, cupboards & sloping ceilings may not appear on the plans. LOCATION PLAN The location plans supplied are for identification purposes only and are reproduced from the Ordnance Survey Map with permission of the Controller of H.M. Stationery Office. Crown Copyright reserved.

