



3 WAVERLEY POINT, ILMINSTER ROAD, SWANAGE
£330,000 SHARED FREEHOLD

This superior apartment is situated on the first floor of a small block of nine in a convenient position approximately 300 metres from the town centre and seafront. Immaculately presented and finished throughout with a stylish neutral decor, the apartment has the advantage of underfloor heating, private balcony, lift access, secure store and dedicated undercroft parking. It is an ideal main residence or investment property in the heart of the town, close to the beach. The furniture is available by separate negotiation if required.

Waverley Point was constructed in 2013 and has external elevations of part brick, cement render and fibreglass weather boarding, under a flat roof covered with mineral felt or similar material.

Swanage lies at the Eastern tip of the Isle of Purbeck delightfully situated between the Purbeck Hills. It has a fine, safe, sandy beach, and is an attractive mixture of old stone cottages and more modern properties, all of which blend in well with the peaceful surroundings. To the South is Durlston Country Park renowned for being the gateway to the Jurassic Coast and World Heritage Coastline.

Viewing is strictly by appointment through the Sole Agents, **Corbens, 01929 422284**. The Postcode for SATNAV is **BH19 1EN**.

Property Reference ILM2112

Council Tax Band D - £2,689.44 2025/26



The entrance hall with recessed storage cupboard leads to the generously sized open plan living room/kitchen with double glazed sliding doors leading to the glazed balcony. This room spans the width of the apartment and enjoys a dual aspect. and has wooden flooring The kitchen area is fitted with a range of contemporary units, contrasting worktops and integrated appliances including electric oven, gas hob, dishwasher and fridge freezer. In addition, there is a utility cupboard with plumbing for an automatic washing machine.

There are two good sized double bedrooms. The principal bedroom enjoys a South & East aspect and has a feature brick glass window the advantage of recessed wardrobes and a luxury en-suite shower room. Bedroom two is also a good sized double bedroom with small recessed fitted wardrobe. The family bathroom is also fitted with a luxury suite and completes the accommodation.

Outside, there are well tended communal grounds to the front. At the rear, there is allocated undercroft parking for one vehicle, which is accessed via a service lane, and two visitors parking spaces. There is also a secure store with a roller door.

TENURE 112 year lease from January 2013. Shared maintenance liability currently £2,240 per annum, payable in 2 instalments. Ground Rent nil. All lettings are permitted, pets at the discretion of the Management Company.

Energy Efficiency Rating

Very energy efficient - lower running costs

Current Potential

(92 plus) **A**

(81-91) **B**

(69-80) **C**

(55-68) **D**

(39-54) **E**

(21-38) **F**

Not energy efficient - higher running costs

Awaiting EPC

Total Floor Area
Approx. 71m² (764 sq ft)

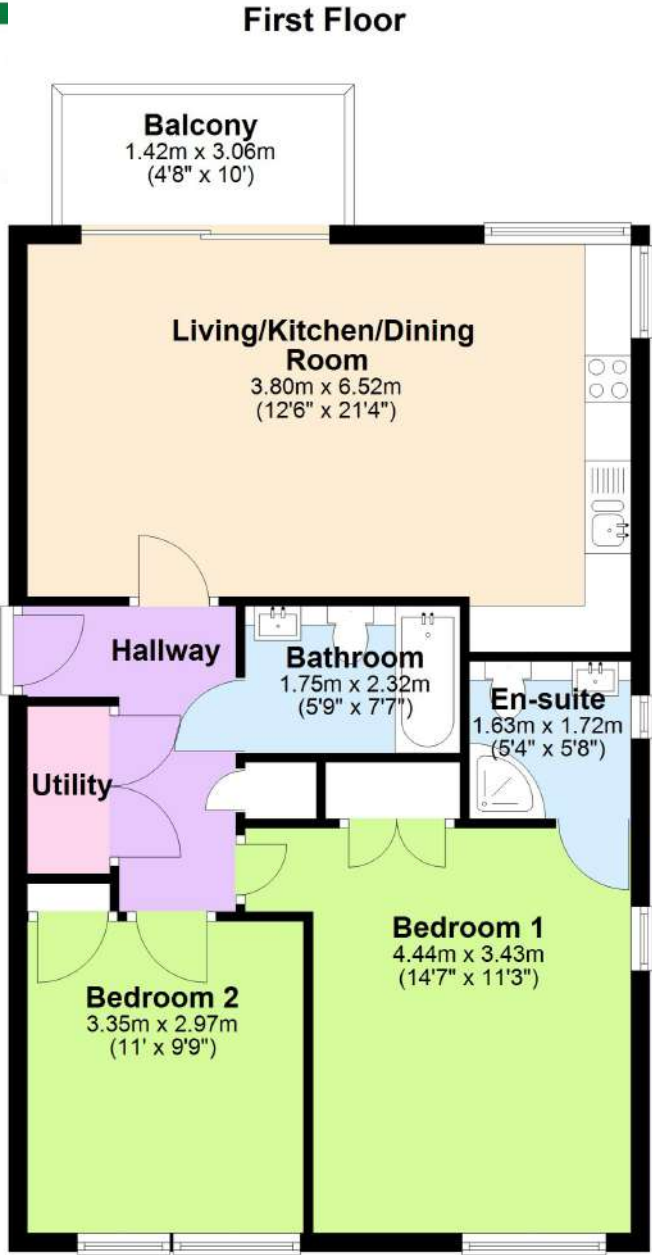

Awaiting Video

Scan to View
Video Tour

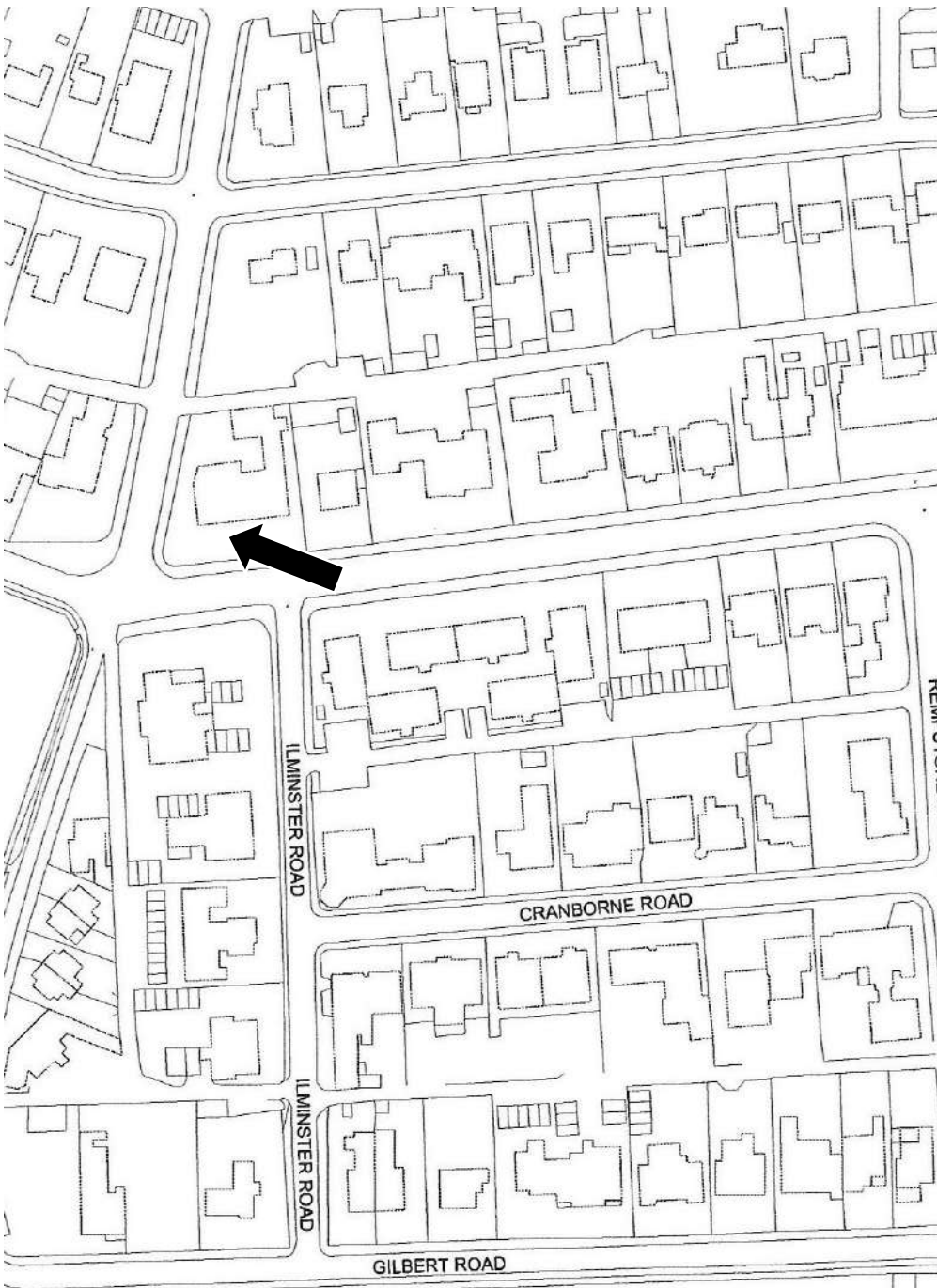

THE PROPERTY MISDESCRIPTION ACT 1991 You are advised to check the availability of this property before travelling any distance to view. The Agent has not tested any apparatus, equipment, fixtures and fittings or services and so cannot verify that they are in working order or fit for the purpose. References to the Tenure of a Property are based on information supplied by the Seller. The area of the building is given for guidance purposes only and must be verified by the purchasers surveyor. A Buyer is advised to obtain verification of this information from their Solicitor and/or Surveyor. FLOOR PLANS The floor plans supplied are for guidance purposes only and should not be used for measuring. Small recesses, cupboards & sloping ceilings may not appear on the plans. LOCATION PLAN The location plans supplied are for identification purposes only and are reproduced from the Ordnance Survey Map with permission of the Controller of H.M. Stationery Office. Crown Copyright reserved.

