

Total area: approx. 91.8 sq. metres (987.8 sq. feet)

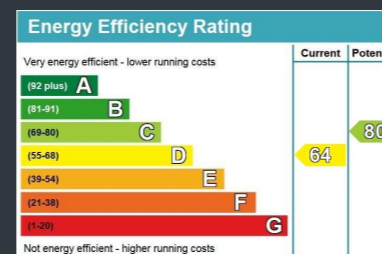

34 St James Road, West End  
Southampton, Hampshire SO30 3FU

£430,000 Freehold

A well-presented and spacious bungalow located in the heart of West End village with walking distance of the shops and village centre. The property has been a long term and well-loved home and benefits from three bedrooms, two reception rooms, a fitted kitchen and modern wet room/shower. Outside, the gardens are very pretty - wrapping around the property - and low maintenance. There is a driveway with parking for one vehicle as well as a garage. **Council Tax Band D. EPC Rating D.**

IMPORTANT: We would like to inform prospective purchasers that these sales particulars have been prepared as a general guide only. A detailed survey has not been carried out, nor the services, appliances and fittings tested. Room sizes should not be relied upon for furnishing purposes and are approximate. If floorplans are included they are for guidance and illustration purposes only and may not be to scale. If there are any important matters likely to affect your decision to buy, please contact us before viewing the property.



## Overview

- THREE BEDROOM BUNGALOW
- DETACHED
- TWO RECEPTION ROOMS
- GREAT WEST END LOCATION
- GARAGE
- OFF ROAD PARKING
- FRONT AND REAR GARDENS
- WET ROOM
- WALK TO SHOPS AND AMENITIES
- EASY ACCESS TO M27/M3 AND BUS ROUTES



A well-presented and spacious bungalow located in the heart of West End village within walking distance of the shops and village centre. The property has been a long term and well-loved home and benefits from good sized rooms throughout. The entrance hall leads to the three bedrooms on one side - two doubles and a single. On the other side of the hall is a spacious dual aspect living room with double doors to the garden and a fireplace. The kitchen is fitted and goes through to a large and light dining/family room, with a window and double doors to the garden. The bathroom was modernised recently with a walk-in shower, basin and low level WC.

Outside, the gardens are very pretty - wrapping around the property - and low maintenance, shingled with mature shrubs and plants. A shed and raised paved area. There is a driveway with parking for one vehicle as well as a garage.

**EPC Rating - D**

**Council Tax Band - D**

**Tenure - Freehold**

**Agent Notes - Draft Copy of Particulars.**

### Sales Disclaimer (OVM)

These particulars are believed to be correct and have been verified by or on behalf of the Vendor. However any interested party will satisfy themselves as to their accuracy and as to any other matter regarding the Property or its location or proximity to other features or facilities which is of specific importance to them. Distances and areas are only approximate and unless otherwise stated fixtures contents and fittings are not included in the sale. Prospective purchasers are always advised to commission a full inspection and structural survey of the Property before deciding to proceed with a purchase.

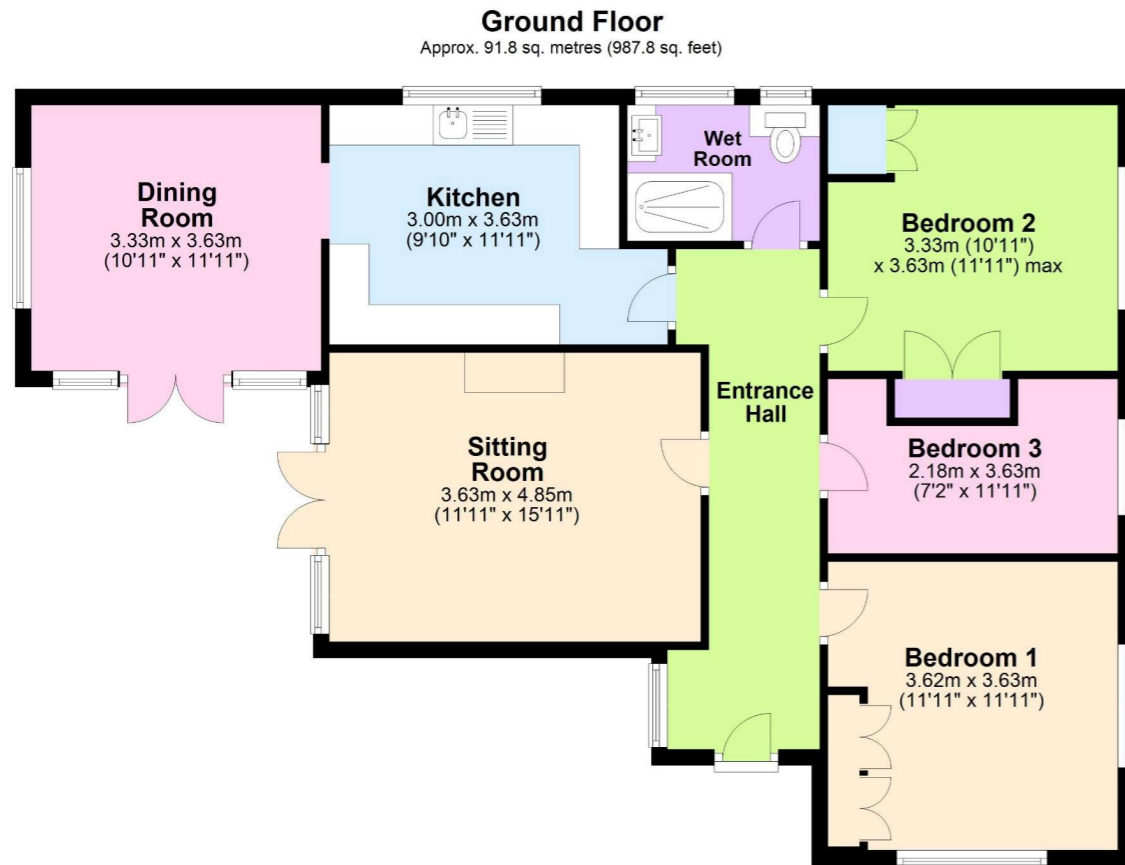

Total area: approx. 91.8 sq. metres (987.8 sq. feet)

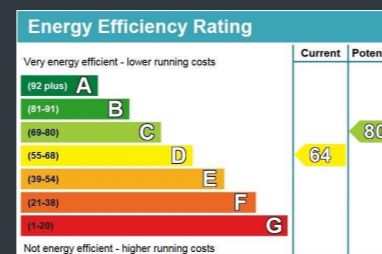

34 St James Road, West End  
Southampton, Hampshire SO30 3FU

£430,000 Freehold

A well-presented and spacious bungalow located in the heart of West End village with walking distance of the shops and village centre. The property has been a long term and well-loved home and benefits from three bedrooms, two reception rooms, a fitted kitchen and modern wet room/shower. Outside, the gardens are very pretty - wrapping around the property - and low maintenance. There is a driveway with parking for one vehicle as well as a garage. **Council Tax Band D. EPC Rating D.**

IMPORTANT: We would like to inform prospective purchasers that these sales particulars have been prepared as a general guide only. A detailed survey has not been carried out, nor the services, appliances and fittings tested. Room sizes should not be relied upon for furnishing purposes and are approximate. If floorplans are included they are for guidance and illustration purposes only and may not be to scale. If there are any important matters likely to affect your decision to buy, please contact us before viewing the property.



## Overview

- THREE BEDROOM BUNGALOW
- DETACHED
- TWO RECEPTION ROOMS
- GREAT WEST END LOCATION
- GARAGE
- OFF ROAD PARKING
- FRONT AND REAR GARDENS
- WET ROOM
- WALK TO SHOPS AND AMENITIES
- EASY ACCESS TO M27/M3 AND BUS ROUTES



A well-presented and spacious bungalow located in the heart of West End village within walking distance of the shops and village centre. The property has been a long term and well-loved home and benefits from good sized rooms throughout. The entrance hall leads to the three bedrooms on one side - two doubles and a single. On the other side of the hall is a spacious dual aspect living room with double doors to the garden and a fireplace. The kitchen is fitted and goes through to a large and light dining/family room, with a window and double doors to the garden. The bathroom was modernised recently with a walk-in shower, basin and low level WC.

Outside, the gardens are very pretty - wrapping around the property - and low maintenance, shingled with mature shrubs and plants. A shed and raised paved area. There is a driveway with parking for one vehicle as well as a garage.

**EPC Rating - D**

**Council Tax Band - D**

**Tenure - Freehold**

**Agent Notes - Draft Copy of Particulars.**

### Sales Disclaimer (OVM)

These particulars are believed to be correct and have been verified by or on behalf of the Vendor. However any interested party will satisfy themselves as to their accuracy and as to any other matter regarding the Property or its location or proximity to other features or facilities which is of specific importance to them. Distances and areas are only approximate and unless otherwise stated fixtures contents and fittings are not included in the sale. Prospective purchasers are always advised to commission a full inspection and structural survey of the Property before deciding to proceed with a purchase.

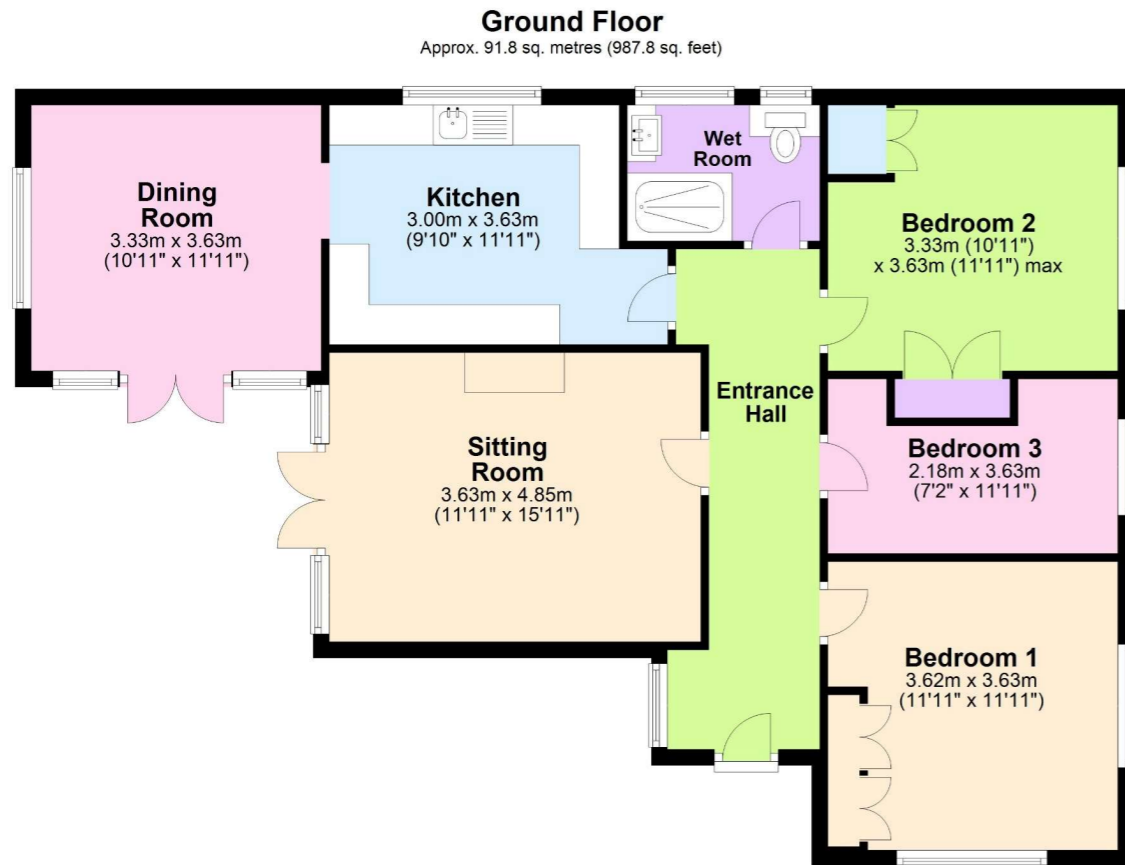

Total area: approx. 91.8 sq. metres (987.8 sq. feet)

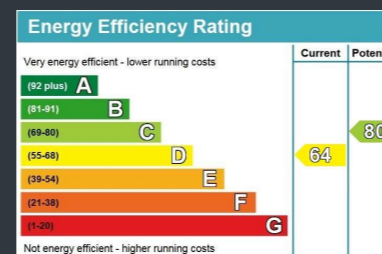

34 St James Road, West End  
Southampton, Hampshire SO30 3FU

£430,000 Freehold

A well-presented and spacious bungalow located in the heart of West End village with walking distance of the shops and village centre. The property has been a long term and well-loved home and benefits from three bedrooms, two reception rooms, a fitted kitchen and modern wet room/shower. Outside, the gardens are very pretty - wrapping around the property - and low maintenance. There is a driveway with parking for one vehicle as well as a garage. **Council Tax Band D. EPC Rating D.**

IMPORTANT: We would like to inform prospective purchasers that these sales particulars have been prepared as a general guide only. A detailed survey has not been carried out, nor the services, appliances and fittings tested. Room sizes should not be relied upon for furnishing purposes and are approximate. If floorplans are included they are for guidance and illustration purposes only and may not be to scale. If there are any important matters likely to affect your decision to buy, please contact us before viewing the property.



## Overview

- THREE BEDROOM BUNGALOW
- DETACHED
- TWO RECEPTION ROOMS
- GREAT WEST END LOCATION
- GARAGE
- OFF ROAD PARKING
- FRONT AND REAR GARDENS
- WET ROOM
- WALK TO SHOPS AND AMENITIES
- EASY ACCESS TO M27/M3 AND BUS ROUTES



A well-presented and spacious bungalow located in the heart of West End village within walking distance of the shops and village centre. The property has been a long term and well-loved home and benefits from good sized rooms throughout. The entrance hall leads to the three bedrooms on one side - two doubles and a single. On the other side of the hall is a spacious dual aspect living room with double doors to the garden and a fireplace. The kitchen is fitted and goes through to a large and light dining/family room, with a window and double doors to the garden. The bathroom was modernised recently with a walk-in shower, basin and low level WC.

Outside, the gardens are very pretty - wrapping around the property - and low maintenance, shingled with mature shrubs and plants. A shed and raised paved area. There is a driveway with parking for one vehicle as well as a garage.

**EPC Rating - D**

**Council Tax Band - D**

**Tenure - Freehold**

**Agent Notes - Draft Copy of Particulars.**

### Sales Disclaimer (OVM)

These particulars are believed to be correct and have been verified by or on behalf of the Vendor. However any interested party will satisfy themselves as to their accuracy and as to any other matter regarding the Property or its location or proximity to other features or facilities which is of specific importance to them. Distances and areas are only approximate and unless otherwise stated fixtures contents and fittings are not included in the sale. Prospective purchasers are always advised to commission a full inspection and structural survey of the Property before deciding to proceed with a purchase.

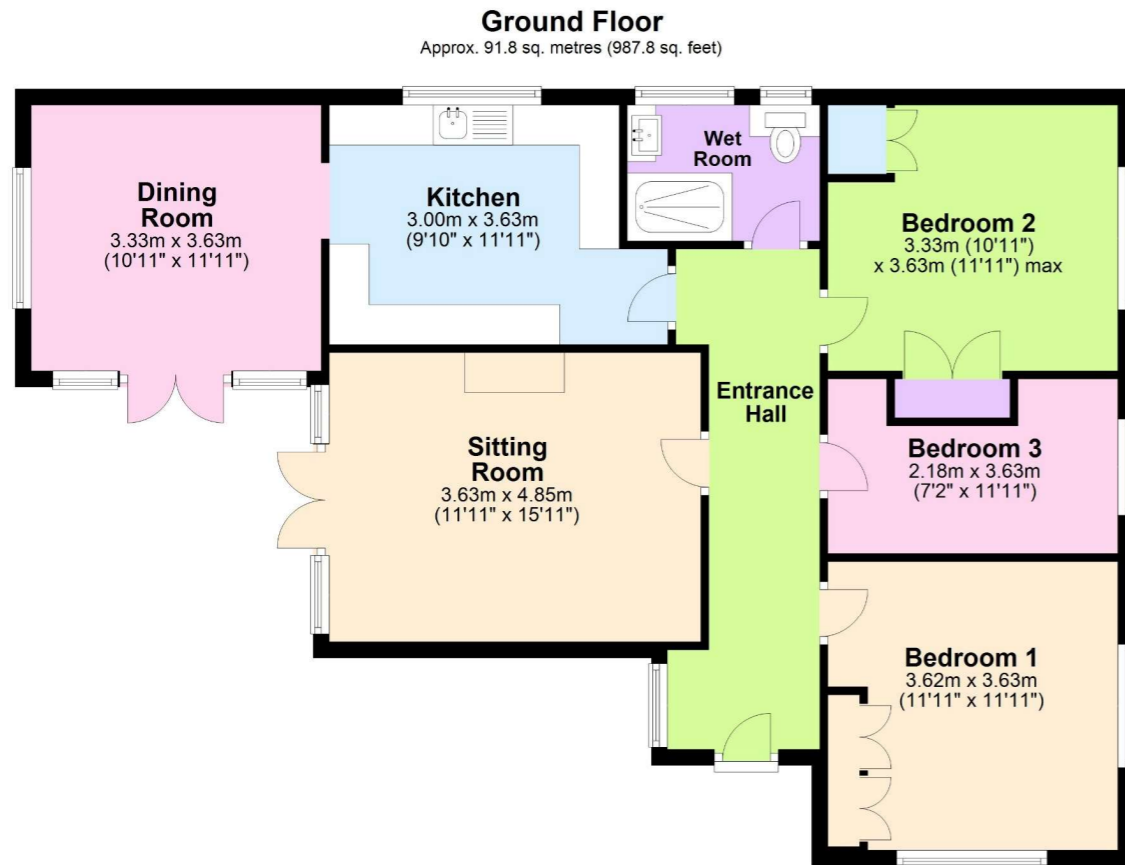

Total area: approx. 91.8 sq. metres (987.8 sq. feet)

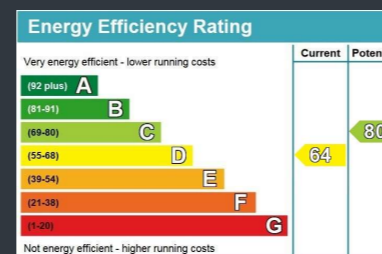

34 St James Road, West End  
Southampton, Hampshire SO30 3FU

£430,000 Freehold

A well-presented and spacious bungalow located in the heart of West End village with walking distance of the shops and village centre. The property has been a long term and well-loved home and benefits from three bedrooms, two reception rooms, a fitted kitchen and modern wet room/shower. Outside, the gardens are very pretty - wrapping around the property - and low maintenance. There is a driveway with parking for one vehicle as well as a garage. **Council Tax Band D. EPC Rating D.**

IMPORTANT: We would like to inform prospective purchasers that these sales particulars have been prepared as a general guide only. A detailed survey has not been carried out, nor the services, appliances and fittings tested. Room sizes should not be relied upon for furnishing purposes and are approximate. If floorplans are included they are for guidance and illustration purposes only and may not be to scale. If there are any important matters likely to affect your decision to buy, please contact us before viewing the property.





## Overview

- THREE BEDROOM BUNGALOW
- DETACHED
- TWO RECEPTION ROOMS
- GREAT WEST END LOCATION
- GARAGE
- OFF ROAD PARKING
- FRONT AND REAR GARDENS
- WET ROOM
- WALK TO SHOPS AND AMENITIES
- EASY ACCESS TO M27/M3 AND BUS ROUTES



A well-presented and spacious bungalow located in the heart of West End village within walking distance of the shops and village centre. The property has been a long term and well-loved home and benefits from good sized rooms throughout. The entrance hall leads to the three bedrooms on one side - two doubles and a single. On the other side of the hall is a spacious dual aspect living room with double doors to the garden and a fireplace. The kitchen is fitted and goes through to a large and light dining/family room, with a window and double doors to the garden. The bathroom was modernised recently with a walk-in shower, basin and low level WC.

Outside, the gardens are very pretty - wrapping around the property - and low maintenance, shingled with mature shrubs and plants. A shed and raised paved area. There is a driveway with parking for one vehicle as well as a garage.

**EPC Rating - D**

**Council Tax Band - D**

**Tenure - Freehold**

**Agent Notes - Draft Copy of Particulars.**

### Sales Disclaimer (OVM)

These particulars are believed to be correct and have been verified by or on behalf of the Vendor. However any interested party will satisfy themselves as to their accuracy and as to any other matter regarding the Property or its location or proximity to other features or facilities which is of specific importance to them. Distances and areas are only approximate and unless otherwise stated fixtures contents and fittings are not included in the sale. Prospective purchasers are always advised to commission a full inspection and structural survey of the Property before deciding to proceed with a purchase.